

CHICAGO O'HARE



LOEWS
HOTELS

Loews Chicago O'Hare Hotel

Why choose between downtown style and the convenience of being just minutes from the airport? At Loews Chicago O'Hare Hotel, guests have the best of both worlds.

5300 N River Road
Rosemont, IL 60018
847.544.5300
[loewshotels.com/
chicago-ohare](https://www.loewshotels.com/chicago-ohare)

Getting Here

Chicago O'Hare International Airport:
10 minutes

Chicago Midway International Airport:
45 minutes

Rooms and Suites

556 guest rooms including
60 spacious suites, featuring
complimentary Wi-Fi, oversized
desks and spa-like bathrooms.

Meetings and Events

41 total meeting rooms, including
4 Grand Ballrooms, for a total of
53,000 square feet of meeting and
event space.

Dining and Entertainment

The Ashburn

Inspired by Chicago's first airport,
Ashburn Flying Field, The Ashburn
is an innovative restaurant that
celebrates the heritage and
tradition of aviation. The Ashburn's
offerings include unique twists and
modern interpretations of classic
American cuisine for all three meal
periods in a contemporary and
relaxed gastropub setting.

Flavor by Loews Hotels:

Eating Like a Local Made Easy

We've brought the local food scene
to you by partnering with some of
our favorite neighborhood food and
drink artisans. Serving it up fresh,
right here in the hotel.

Things to Do

- Fashion Outlets of Chicago
- Big Ten Museum
- Pearl Entertainment District
- Parkway Bank Park
- Rivers Casino
- Impact Field, home of the Chicago Dogs

At Your Service

- Complimentary 24-hour airport shuttle
- 24-hour fitness center
- Coffee shop serving up Starbucks®
brewed coffee alongside a selection
of gifts and personal necessities
- 24-hour business center and
conference concierges
- Valet and self-parking
- Chat Your Service: need a restaurant
reservation or the AC turned up?
Just text us and we've got you covered.
- Whether you're here for business or
leisure, you can count on our services
and amenities for a seamless stay. Now,
enjoy Loews' intuitive service at your
fingertips with the ease of our mobile
app. Download to check-in, check-out
and manage your stay right from your
smartphone.

Meeting Spaces

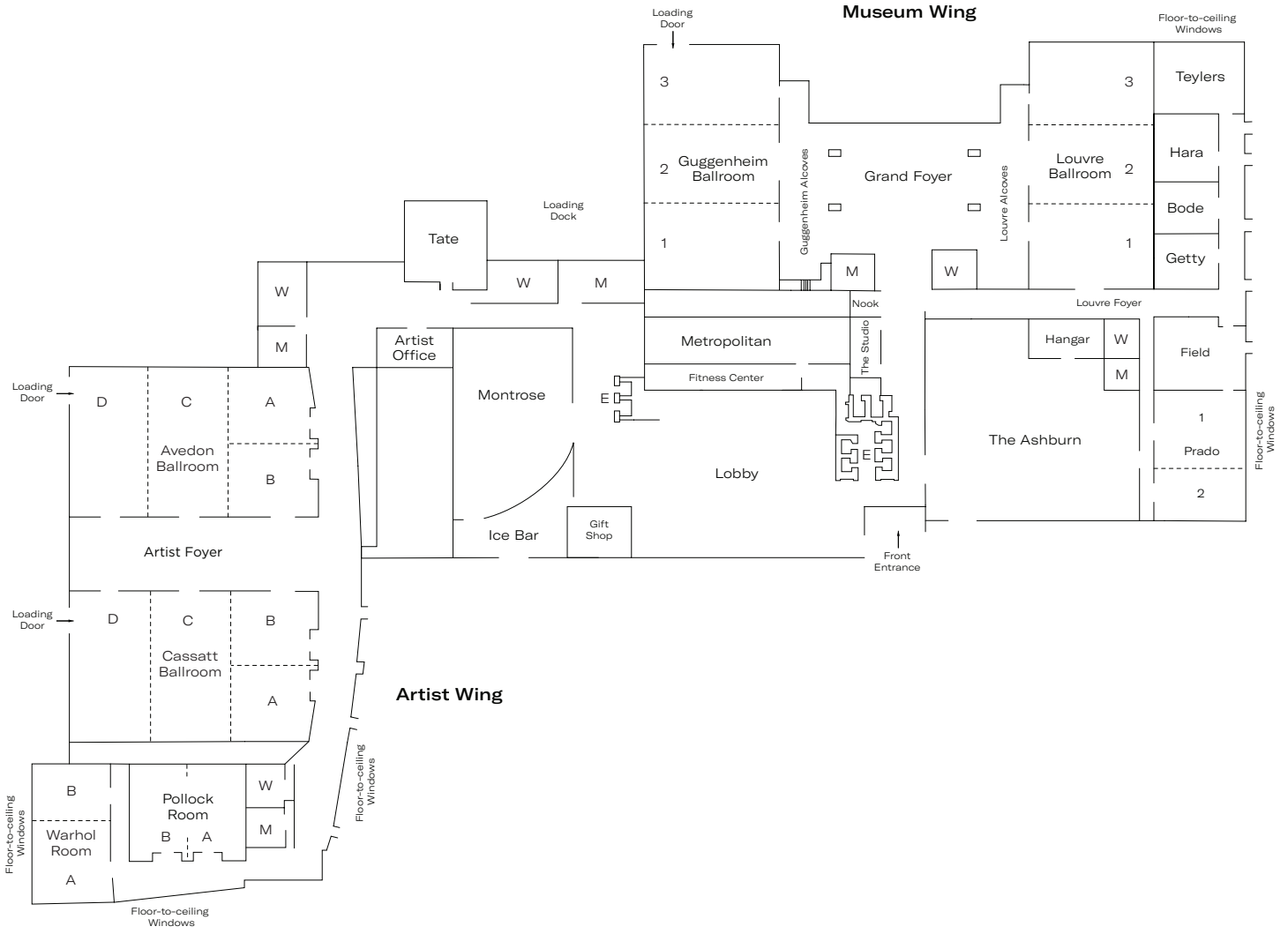

From left: Teylers Meeting Room, Avedon/Cassatt Ballroom

Venue	Dimensions (Ft.)	Sq. Ft.	Ceiling (Ft.)	Windows
Level 1				
Guggenheim Ballroom	63 x 116	7,159	15	No
Guggenheim 1	63 x 38	2,377	15	No
Guggenheim 2	63 x 39	2,407	15	No
Guggenheim 3	63 x 38	2,376	15	No
Louvre Ballroom	60 x 117	6,672	15	No
Louvre 1	60 x 39	2,229	15	No
Louvre 2	60 x 39	2,196	15	No
Louvre 3	60 x 39	2,247	15	No
Grand Foyer and Alcoves	100 x 49	4,900	10	No
Grand Foyer	60 x 49	2,940	10	No
Guggenheim Alcoves	19 x 49	936	10	No
Louvre Alcoves	19 x 49	936	10	No
Louvre Foyer	111 x 11	1,234	10	No
Nook	7 x 23	163	10	No
The Studio	28 x 16	448	9.5	No
Teylers	47 x 31	1,335	16	Yes
Hara	12 x 27	350	10	No
Bode	16 x 26	446	10	No
Getty	16 x 26	458	10	No
Field	28 x 35	924	15	Yes
Prado	62 x 31	1,687	13	Yes
Prado 1	33 x 31	877	13	Yes
Prado 2	29 x 31	810	13	Yes
Hangar	15 x 22	368	10	No
Gallery 424-824*	19 x 32	492	8	No
Gallery 924-1224*	19 x 31	472	8	No
Metropolitan	64 x 48	2,237	10	No
Montrose	80 x 99	3,847	10	No
Ice Bar		1,700	12	Yes
Tate	25 x 37	930	15	No
Artist Office	14 x 12	162	13	No
Artist Foyer	143 x 283	11,022	17	Yes
Avedon Ballroom	110 x 71	7,746	16	No
Avedon A	36 x 38	1,333	16	No
Avedon B	35 x 38	1,319	16	No
Avedon C	71 x 35	2,456	16	No
Avedon D	71 x 38	2,639	16	No
Cassatt Ballroom	110 x 71	7,722	16	No
Cassatt A	35 x 38	1,321	16	No
Cassatt B	35 x 38	1,328	16	No
Cassatt C	71 x 35	2,449	16	No
Cassatt D	71 x 38	2,638	16	No
Pollock Room	41 x 50	2,114	15	No
Pollock A	44 x 25	1,057	15	No
Pollock B	44 x 25	1,057	15	No
Warhol Room	65 x 33	2,134	15	Yes
Warhol A	36 x 36	1,163	15	Yes
Warhol B	35 x 30	971	15	Yes

*Gallery rooms located next to elevators on corresponding guest room floor.

Classroom	Theatre	Rounds	Conference	U-Shape	Hollow Square	Exhibition
Level 1						
468	612	600	98	96	108	34
144	204	180	48	54	60	11
144	204	180	48	54	60	11
144	204	180	48	54	60	11
429	612	600	98	93	102	34
132	204	180	48	56	60	10
132	204	180	48	56	60	10
132	204	180	48	56	60	10
60	140	96	30	36	36	6
18	35	24	18	21	21	
30	40	24	18	21	21	
27	40	24	18	21	21	
60	60	72	24	27	27	4
72	140	120	36	34	42	
36	70	60	18	24	30	
36	70	60	18	24	30	
		12	8	10	12	
24	25	38	15	15	18	
			16			
48	70	72	30	39	48	
160	300	216	30	42	48	12
		50	16			
48	88	72	24	30	30	4
		12	10	8		
540	798	720		123	150	34
75	98	72	24	33	42	6
75	98	72	24	33	42	6
165	224	216	42	54	60	12
165	224	216	42	54	60	12
540	798	720		123	150	34
75	98	72	24	33	42	6
75	98	72	24	33	42	6
165	224	216	42	54	60	12
165	224	216	42	54	60	12
120	190	144	30	42	51	7
54	84	72	24	30	36	5
54	84	72	24	30	36	5
123	196	180	48	57	66	9
66	80	108	27	33	42	5
54	98	72	24	27	36	5



Top to bottom: Lobby, Deluxe Room