

CHICAGO



LOEWS
HOTELS

Loews Chicago Hotel

Sitting along the north side of the Chicago River, Loews Chicago Hotel offers easy access to the Magnificent Mile, Navy Pier and The Loop—a perfect combination of business and leisure.

455 North Park Drive
Chicago, IL 60611

312.840.6600

[loewshotels.com/chicago](https://www.loewshotels.com/chicago)

Getting Here

Chicago O'Hare International Airport:
19 miles

Chicago Midway International Airport:
12 miles

Rooms and Suites

400 guest rooms including 25 indulgent suites with spectacular skyline, river or lake views.

Meetings and Events

- 31,000 total square feet of meeting space
- 8,500 square foot Wright Ballroom
- 4,800 square foot Sullivan Ballroom
- 9,000 square foot outdoor terrace
- Flexible breakout rooms
- Dedicated meeting planner offices

Dining and Entertainment

ETA Restaurant + Bar

Serving rustic American fare for breakfast, lunch and dinner.

Streeterville Social

Downtown Chicago's go-to summertime rooftop terrace.

Flavor by Loews Hotels:

Eating Like a Local Made Easy

We've brought the local food scene to you by partnering with some of our favorite neighborhood food and drink artisans. Serving it up fresh, right here in the hotel.

Things to Do

- 24-hr fitness center with 75-ft indoor lap pool and two fully-connected Peloton bikes
- 15 minute walk to The Loop
- 10 minute walk to Millennium Park and "The Bean"
- 10 minute walk to Navy Pier
- 5 minute walk to the shopping and nightlife of the Magnificent Mile

At Your Services

- Full service Starbucks® in lobby
- 24-hr business center and conference concierge
- 24-hr in-room dining
- Valet and self-parking
- Chat Your Service: need a restaurant reservation or the AC turned up? Just text us and we've got you covered.

Outdoors

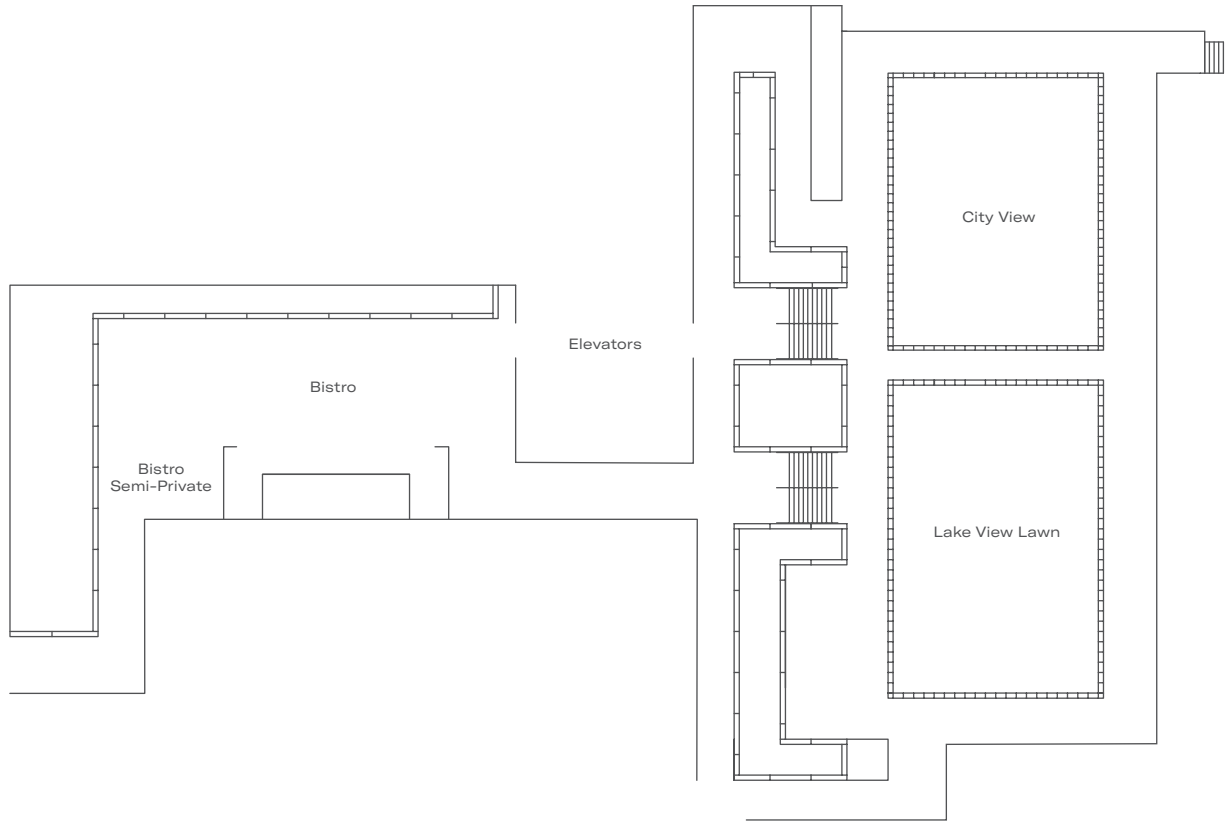

Room	Dimensions (Ft.)	Sq. Ft.	Ceiling (Ft.)	Classroom	Theater	Reception	Banquet	U-Shape	Hollow Square	Conference
Function Areas										
Garden Terrace	65 × 138	8,970			698	690	450			
City View Lounge	65 × 64	4,160			329	175				
Lake View Lawn	65 × 74	4,810			369	400	400			
The Bistro	82 × 26	2,132				100	70			

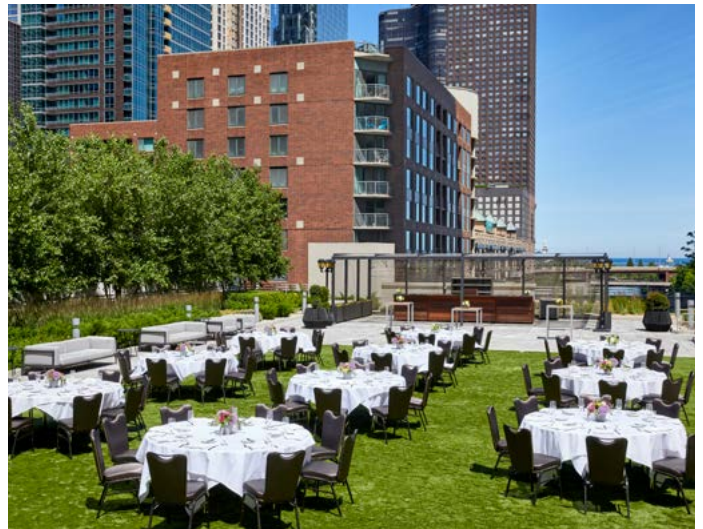

From left: City View Lounge and Lake View Lawn



Top to bottom: Maher and Wright Ballroom

First Level

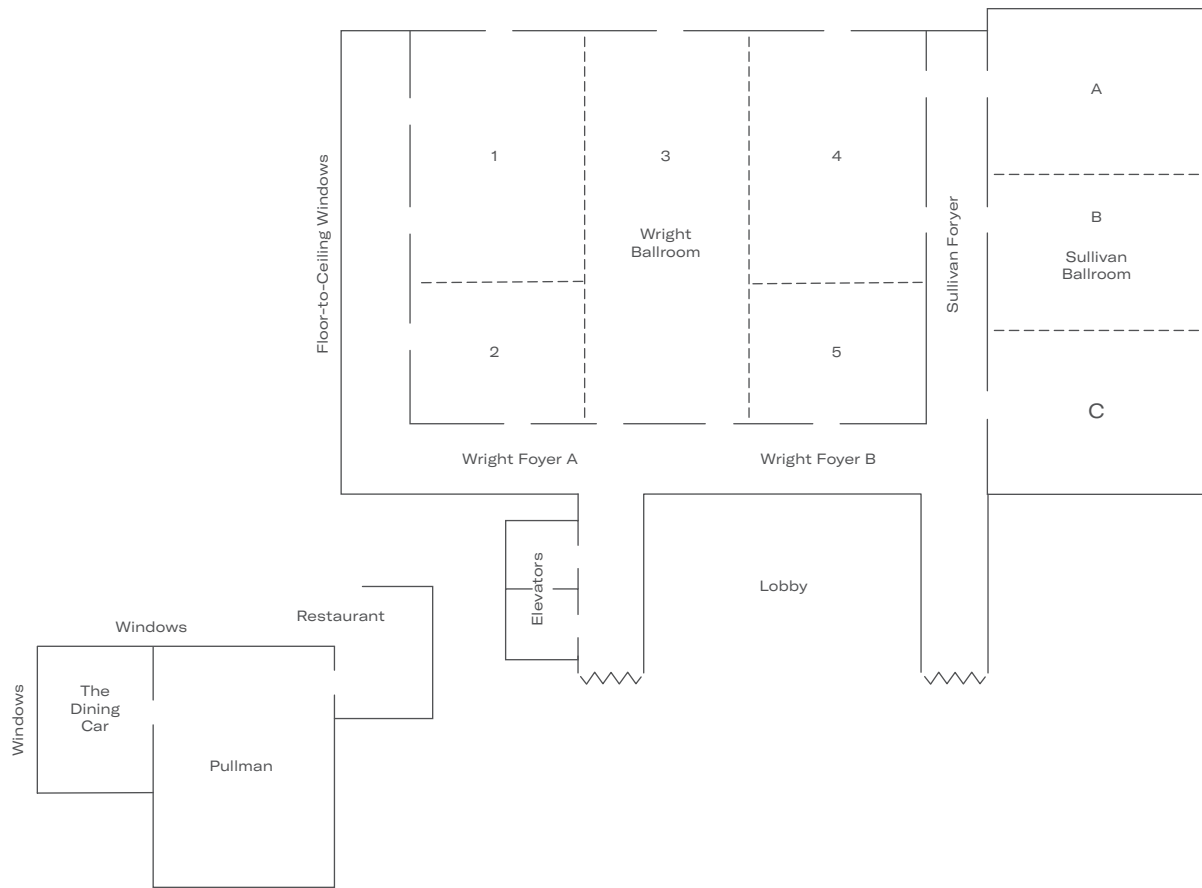

Room	Dimensions (Ft.)	Sq. Ft.	Ceiling (Ft.)	Classroom	Theater	Reception	Banquet	U-Shape	Hollow Square	Conference
Wright Ballroom										
Wright Ballroom	109 × 78	8,502	19	504	698	830	660			
Wright 1 or 4	51 × 35	1,785	19	108	182	250	144	48	60	36
Wright 2 or 5	27 × 35	945	19	60	103	120	70	33	36	24
Wright 1, 2 or 4, 5	78 × 35	2,730	19	162	266	275	216	69	78	60
Wright 3	78 × 38	2,964	19	162	252		216	63	78	66
Wright 1, 2, 3 or 3, 4, 5	78 × 73	5,694	19	324	480	520	516	87	114	
Wright Foyer										
West Extension	66 × 12	792	24							
South Extension	143 × 23	3,289	12			350				
Sullivan Ballroom										
Sullivan Ballroom	46 × 106	4,876	18	297	450	450	400	93	108	84
Sullivan Ballroom A, B, or C	46 × 35	1,610	18	96	154	150	144	42	54	36
Sullivan Ballroom A, B or B, C	46 × 75	3,450	18	192	308	300	288	84	108	72
Sullivan Foyer	14 × 86	1,204	12			150				
Unique Spaces										
Pullman	51 × 24	1,224	10	90	132	150	108	42	48	42
The Dining Car	35 × 23	805	10	42	70	80	60	30	30	30

Second Level

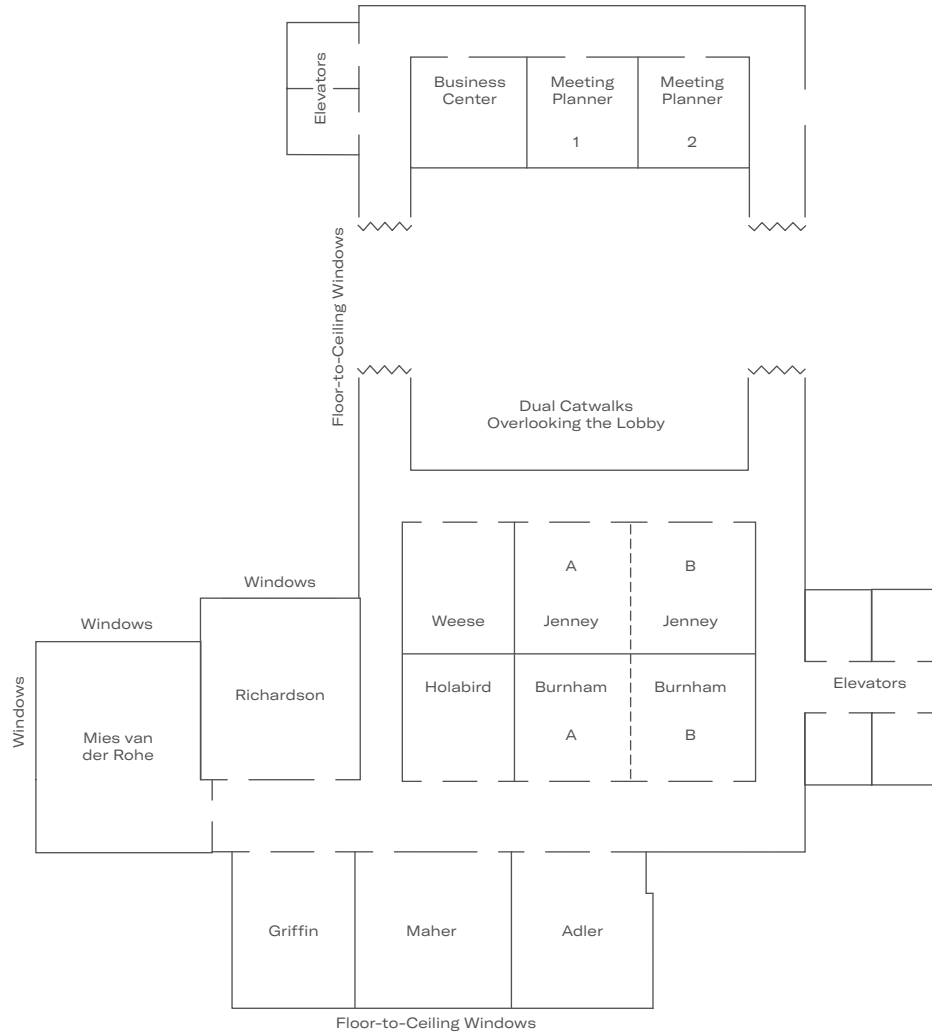

Room	Dimensions (Ft.)	Sq. Ft.	Ceiling (Ft.)	Classroom	Theater	Reception	Banquet	U-Shape	Hollow Square	Conference
Function Areas										
Mies van der Rohe	32 × 28	896	10	54	108	100	72	33	42	28
Jenney	20 × 44	880	10	54	92	90	60	36	42	36
Jenney A or B	20 × 22	440	10	27	44	35	36	18	18	12
Burnham	20 × 44	880	10	54	89	90	60	33	36	36
Burnham A or B	20 × 22	440	10	27	44	35	36	18	18	12
Adler	23 × 28	644	10	36	69	60	60	27	30	18
Weese	20 × 19	380	10	18	30	30	24	15	18	12
Holabird	20 × 19	380	10	18	30	30	24	15	18	12
Maher	25 × 28	700	10	45	84	84	60	27	30	24
Richardson	25 × 27	675	10	36	73	73	60	26	30	24
Griffin	16 × 28	448	10	18	30	30	24	15	18	12
Meeting Planner 1 or 2	17 × 12	204	10				10			6