

KANSAS CITY



LOEWS
HOTELS

Loews Kansas City Hotel

Experience a new era of hospitality and be just steps away from exciting dining, shopping and entertainment options in a re-energized downtown Kansas City.

1515 Wyandotte Street
Kansas City, MO 64108
816.897.7070
[loewshotels.com/
loews-kansas-
city-hotel](http://loewshotels.com/loews-kansas-city-hotel)

Getting Here

Kansas City International Airport:
25 minute drive

Rooms and Suites

800 guestrooms including:

- 380 rooms with king beds
- 373 rooms with two queen beds

47 stylish suites including:

- One presidential suite
- Four vice presidential suites
- 17 corner suites
- 19 grand suites
- Three studio suites
- Three terrace suites

Meetings and Events

Approximately 60,000 sq. ft. of function space, featuring 22 meeting and banquet rooms, two oversized ballrooms, one of the largest in the city, three boardrooms, and a 6,000 sq. ft. outdoor terrace.

Private dining events available at hotel restaurant, up to 114 guests.

Dining and Entertainment

Bar Stilwell

Our lobby bar features custom cocktails and a creative take on American fare that celebrates Kansas City's past and present.

The Stilwell

Paying homage to Kansas City's railroad history, our brasserie reinvents great American classics, with BBQ, Bourbon and much more. Enjoy a warm atmosphere and take in the view on our wraparound balcony overlooking downtown and the Power & Light district.

Red Wheat Baking Co.

Our Grab and Go market, featuring artisanal coffee drinks, freshly baked goods, sandwiches and other items perfect for when you're on the move.

Horsefeather Social

Relax and experience views of the Performing Arts Center while grabbing a quick bite and enjoying a local cocktail, craft beer or glass of wine. Horsefeather Social is open seasonally.

Flavor by Loews Hotels:

Eating Like a Local Made Easy

We've brought the local food scene to you by partnering with some of our favorite neighborhood food and drink artisans. Serving it up fresh, right here in the hotel.

Things to Do

- State-of-the-art fitness center
- Full-service spa with five treatment rooms
- Indoor lap pool and jacuzzi
- Walking distance to Kansas City Power & Light District, T-Mobile Center, KC Streetcar and the Kauffman Center for the Performing Arts

At Your Service

- Business center
- 24-hour room service
- High-speed internet access
- Valet and self-parking
- Connector bridge to the Kansas City Convention Center
- Chat Your Service: Need a restaurant reservation or the AC turned up? Just text us and we've got you covered.



From top: Neptune Ballroom, Brush Creek meeting room



Clockwise from top: City Beautiful Ballroom, Event Lawn, King guest room

Meeting Space

Room	Dimensions (Ft.)	Sq. Ft.	Theater	Rounds of 10	Reception	Classroom	Boardroom	U-Shape	Half Rounds	Hollow Square	Exhibits
Neptune Ballroom	147 × 88	12,936	1,200	840	924	798			504		81
Neptune A	29 × 47	1,363	120	80	97	72	40	39	36	54	
Neptune B	30 × 47	1,410	120	80	101	72	40	39	48	54	
Neptune C	29 × 47	1,363	120	80	97	72	40	39	48	54	
Neptune A, B, C	88 × 47	4,136	360	280	295	306	78	84	150	102	27
Neptune D	88 × 38	3,344	270	210	239	240	78	78	126	90	18
Neptune E	88 × 62	5,456	495	350	390	384	78	90	186	114	36
Neptune Foyer		5,822		120	416						
Muse A	34 × 36	1,224	100	60	87	60	28	33	48	36	
Muse B	30 × 36	1,080	100	60	77	48	28	27	54	30	
Muse	64 × 44	2,816	240	150	201	177	58	60	90	72	
Mermaid A	33 × 40	1,320	120	80	94	75	40	42	54	66	
Mermaid B	40 × 40	1,600	140	80	114	81	40	42	66	66	
Mermaid	73 × 40	2,920	220	160	209	189	64	63	96	78	
Leadership	45 × 25	1,125	70	60	80	63	36	36	48	42	
Northland	41 × 34	1,394	110	90	100	84	36	36	72	42	
Bacchus	41 × 33	1,353	110	90	97	84	36	36	72	42	
Pomona	41 × 32	1,312	110	90	95	84	36	36	72	42	
Meeting Planner Office	11 × 13	143									
City Beautiful Ballroom	214 × 126	26,964	2,080	1,600	1,863	1,701			960		193
City Beautiful A	41 × 66	2,706	200	150	193	180	52	63	90	78	
City Beautiful B	41 × 66	2,706	200	150	193	180	52	63	90	78	
City Beautiful C	42 × 66	2,772	200	150	198	180	52	63	90	78	
City Beautiful A, B, C	126 × 66	8,316	640	500	594	540		129	300	150	49
City Beautiful D	126 × 68	8,568	640	500	612	540		129	300	150	54
City Beautiful E	126 × 73	9,198	660	500	657	540		129	300	150	56
City Beautiful Foyer		11,069		230	791						32
Spirit of Freedom	26 × 15	390	32	20	28	24	22	15	18	18	
Waterworks Spectacular	29 × 14	406	32	20	29	24	22	15	18	18	
Brush Creek	30 × 18	540	32	30	39	24	22	15	24	18	
Sea Horse	29 × 19	551	36	40	39	27	22	15	24	18	
City of Fountains A	24 × 14	336	14								
City of Fountains B	22 × 17	374	21	20	27	21	20	18	12	21	
City of Fountains C	23 × 17	391	21	20	28	21	20	18	12	21	
Seventh Floor—All with Murphy Bed											
Meeting Suite 715		700	24	20	35	18	12		12		
Meeting Suite 755		700	24	20	35	18	12		12		
Meeting Suite 717		500	20	10	25		6		6		

Room	Dimensions (Ft.)	Sq. Ft.	Theater	Rounds of 10	Reception	Classroom	Boardroom	U-Shape	Half Rounds	Hollow Square	Exhibits
------	------------------	---------	---------	--------------	-----------	-----------	-----------	---------	-------------	---------------	----------

Sixth Floor—All with Murphy Bed

Meeting Suite 632		500	20	20	36	12	14		6		
Meeting Suite 634		500	20	20	36	12	14		6		
Meeting Suite 636		500	20	20	36	12	14		6		

Event Deck (Entire Space)	162 × 70	11,340		380	600						
Event Deck (Green Space)	84 × 44	3,696	360	240	264						

Stilwell Restaurant				225							
Private Dining Room A				48							
Private Dining Room B				36							
Semi-Private Dining Room C				30							

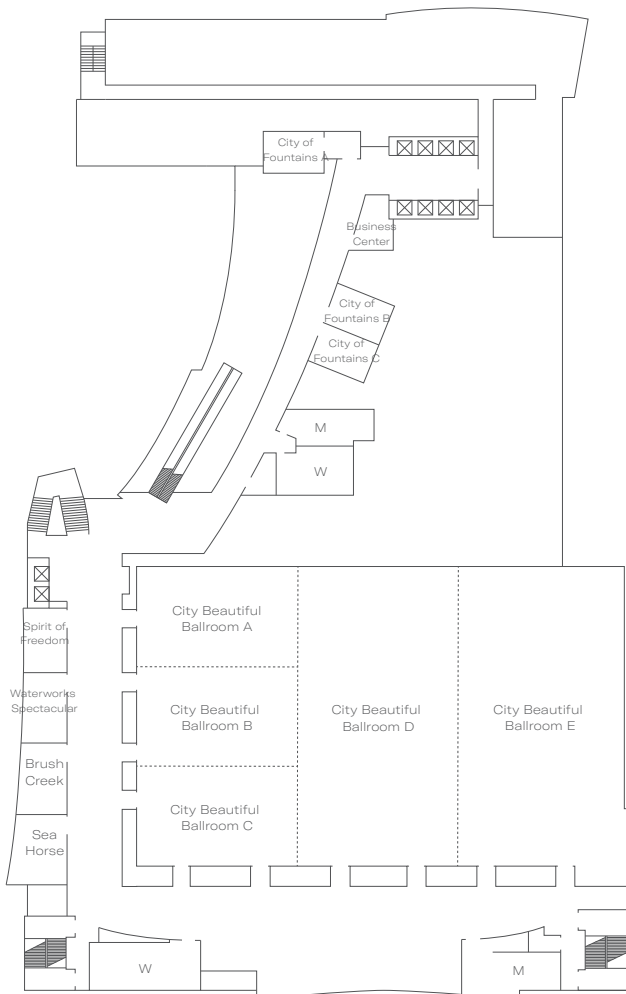

Ballroom Level

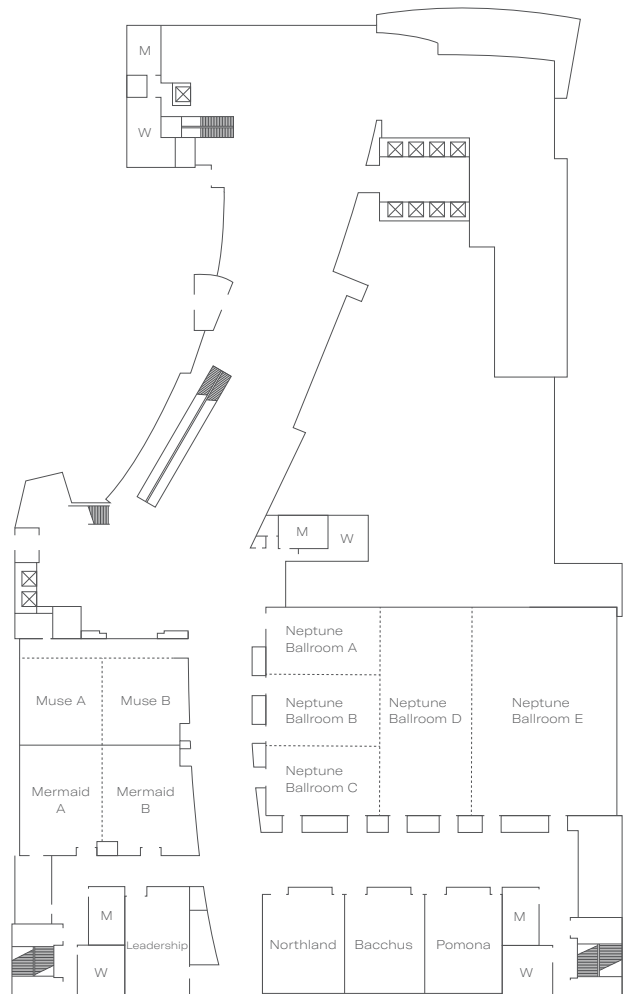

Junior Ballroom Level