

CHICAGO O'HARE



LOEWS
HOTELS

Loews Chicago O'Hare Hotel

Why choose between downtown style and the convenience of being just minutes from the airport? At the newly refreshed Loews Chicago O'Hare Hotel, guests have the best of both worlds.

5300 N River Road
Rosemont, IL 60018
847.544.5300
[loewshotels.com/
chicago-ohare](http://loewshotels.com/chicago-ohare)

Getting Here

Chicago O'Hare International Airport:
10 minutes

Chicago Midway International Airport:
45 minutes

Rooms and Suites

556 newly renovated guest rooms including 60 spacious suites, featuring complimentary Wi-Fi, oversized desks and spa-like bathrooms.

Meetings and Events

53,000 square feet of freshly renovated meeting and event space including four ballrooms, nine private boardrooms and 34 meeting rooms

Dining and Entertainment

The Ashburn

Inspired by Chicago's first airport, Ashburn Flying Field, The Ashburn is an innovative restaurant that celebrates the heritage and tradition of aviation. The Ashburn's offerings include unique twists and modern interpretations of classic American cuisine for all three meal periods in a contemporary and relaxed gastropub setting.

Flavor by Loews Hotels:

Eating Like a Local Made Easy

We've brought the local food scene to you by partnering with some of our favorite neighborhood food and drink artisans. Serving it up fresh, right here in the hotel.

Things to Do

- Maintain your exercise routine at the 24-hour fitness center
- Tour the extensive art collection located throughout the first floor of the hotel
- Shop at over 130 luxury outlet stores at the Fashion Outlets of Chicago
- Enjoy the nightlife offerings of the Entertainment District and the Pearl District

At Your Service

- Complimentary airport shuttle
- Coffee shop serving up Starbucks® brewed coffee alongside a selection of gifts and personal necessities
- 24-hour business center and conference concierges
- Valet and self-parking
- Chat Your Service: need a restaurant reservation or the AC turned up? Just text us and we've got you covered.

Venue	Dimensions (Ft.)	Sq. Ft.	Ceiling (Ft.)	Windows
Level 1				
Guggenheim Ballroom	63 x 116	7,159	15	No
Guggenheim 1	63 x 38	2,377	15	No
Guggenheim 2	63 x 39	2,407	15	No
Guggenheim 3	63 x 38	2,376	15	No
Louvre Ballroom	60 x 117	6,672	15	No
Louvre 1	60 x 39	2,229	15	No
Louvre 2	60 x 39	2,196	15	No
Louvre 3	60 x 39	2,247	15	No
Grand Foyer and Alcoves	100 x 49	4,900	10	No
Grand Foyer	60 x 49	2,940	10	No
Guggenheim Alcoves	19 x 49	936	10	No
Louvre Alcoves	19 x 49	936	10	No
Louvre Foyer	111 x 11	1,234	10	No
Nook	7 x 23	163	10	No
The Studio	28 x 16	448	9.5	No
Teylers	47 x 31	1,335	16	Yes
Hara	12 x 27	350	10	No
Bode	16 x 26	446	10	No
Getty	16 x 26	458	10	No
Field	28 x 35	924	15	Yes
Prado	62 x 31	1,687	13	Yes
Prado 1	33 x 31	877	13	Yes
Prado 2	29 x 31	810	13	Yes
Hangar	15 x 22	368	10	No
Gallery 424-824*	19 x 32	492	8	No
Gallery 924-1224*	19 x 31	472	8	No
Metropolitan	64 x 48	2,237	10	No
Montrose	80 x 99	3,847	10	No
Ice Bar		1,700	12	Yes
Tate	25 x 37	930	15	No
Artist Office	14 x 12	162	13	No
Artist Foyer	143 x 283	11,022	17	Yes
Avedon Ballroom	110 x 71	7,746	16	No
Avedon A	36 x 38	1,333	16	No
Avedon B	35 x 38	1,319	16	No
Avedon C	71 x 35	2,456	16	No
Avedon D	71 x 38	2,639	16	No
Cassatt Ballroom	110 x 71	7,722	16	No
Cassatt A	35 x 38	1,321	16	No
Cassatt B	35 x 38	1,328	16	No
Cassatt C	71 x 35	2,449	16	No
Cassatt D	71 x 38	2,638	16	No
Pollock Room	41 x 50	2,114	15	No
Pollock A	44 x 25	1,057	15	No
Pollock B	44 x 25	1,057	15	No
Warhol Room	65 x 33	2,134	15	Yes
Warhol A	36 x 36	1,163	15	Yes
Warhol B	35 x 30	971	15	Yes

*Gallery rooms located next to elevators on corresponding guest room floor.

Classroom	Theatre	Rounds	Conference	U-Shape	Hollow Square	Exhibition
Level 1						
468	612	600	98	96	108	34
144	204	180	48	54	60	11
144	204	180	48	54	60	11
144	204	180	48	54	60	11
429	612	600	98	93	102	34
132	204	180	48	56	60	10
132	204	180	48	56	60	10
132	204	180	48	56	60	10
60	140	96	30	36	36	6
18	35	24	18	21	21	
30	40	24	18	21	21	
27	40	24	18	21	21	
60	60	72	24	27	27	4
72	140	120	36	34	42	
36	70	60	18	24	30	
36	70	60	18	24	30	
		12	8	10	12	
24	25	38	15	15	18	
			16			
48	70	72	30	39	48	
160	300	216	30	42	48	12
		50	16			
48	88	72	24	30	30	4
		12	10	8		
540	798	720		123	150	34
75	98	72	24	33	42	6
75	98	72	24	33	42	6
165	224	216	42	54	60	12
165	224	216	42	54	60	12
540	798	720		123	150	34
75	98	72	24	33	42	6
75	98	72	24	33	42	6
165	224	216	42	54	60	12
165	224	216	42	54	60	12
120	190	144	30	42	51	7
54	84	72	24	30	36	5
54	84	72	24	30	36	5
123	196	180	48	57	66	9
66	80	108	27	33	42	5
54	98	72	24	27	36	5

Meeting Spaces

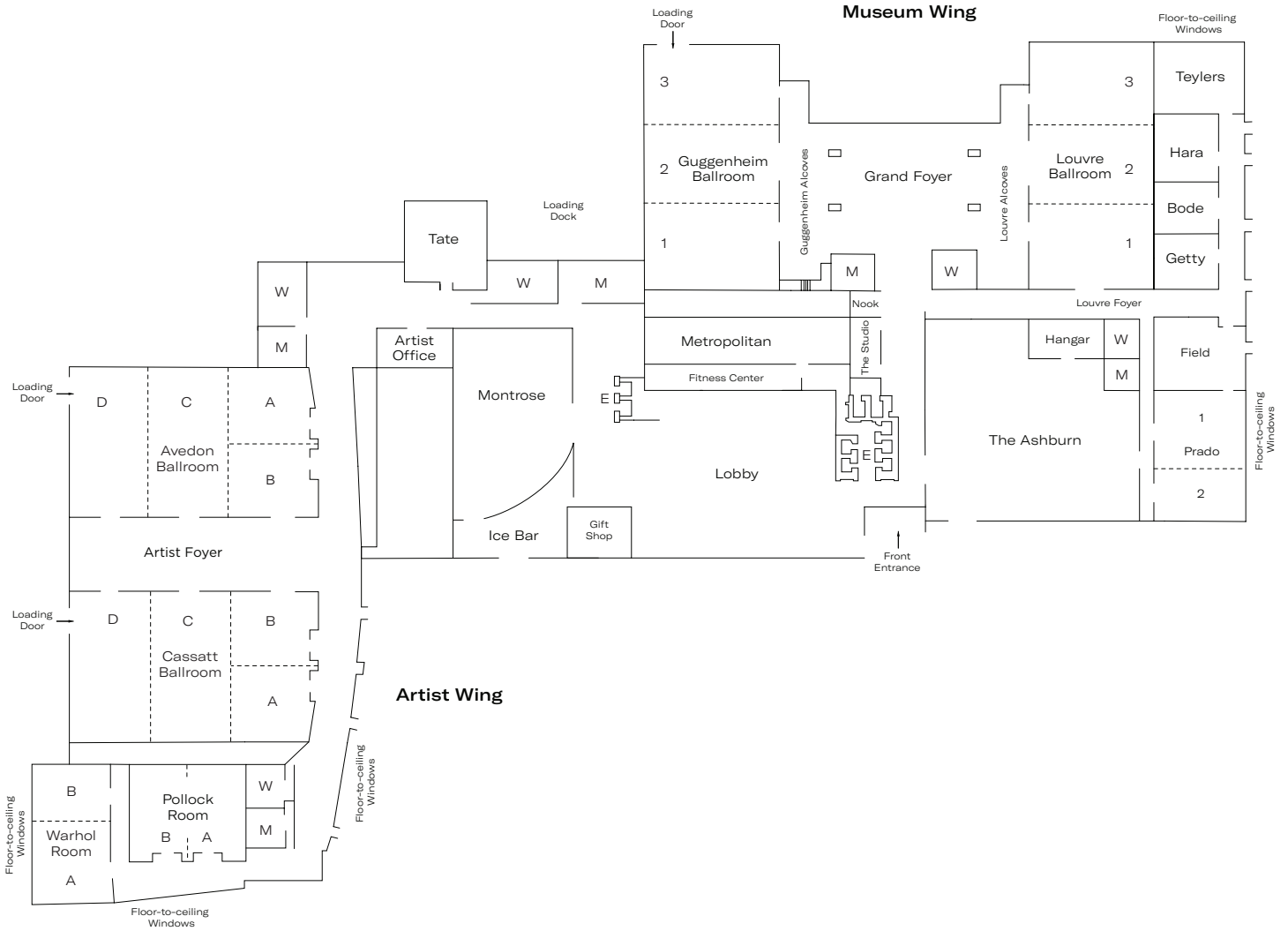

From left: Warhol Room, Avedon/Cassatt Ballroom



Top to bottom: Lobby, Deluxe Room