

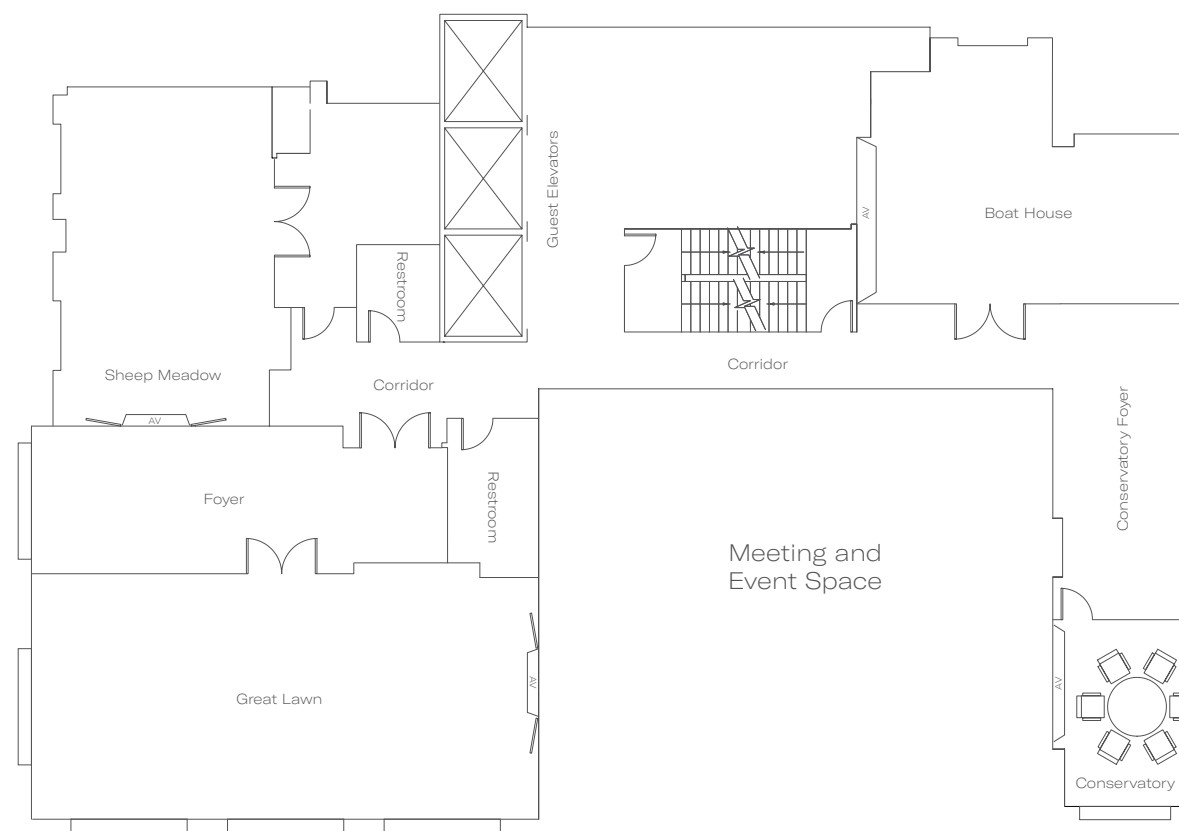

## Meeting and Event Space



Room	Dimensions (Ft.)	Sq. Ft.	Classroom	Theater	Reception	Rounds	Boardroom	Crescent
<b>Meeting and Event Space</b>								
Great Lawn	16'9" x 39'	700	40	75	75	60	30	36
Sheep Meadow	26'6" x 17'	500	24	40	50	30	18	15
Boat House	21'9" x 154"	350	20	50	50	40	15	
Conservatory	14' x 12'	200				8		
Regency Room		800		90	75	60	35	
Park Avenue Private Dining Room		328					20	
The Regency Bar & Grill		3500			275	150		





# Loews Regency New York Hotel

Situated with access to all that the city has to offer, the Loews Regency New York Hotel blends the history of New York with a unique emerging cultural scene.

540 Park Avenue  
New York, NY 10065  
212.339.4034  
[loewshotels.com/  
regency](http://loewshotels.com/regency)

## Getting Here

LaGuardia Airport (LGA):  
7 miles, 25 minutes

John F. Kennedy Airport (JFK):  
16 miles, 45 minutes

Eight Subway lines within four blocks

Hotel car service within 20 blocks

## Rooms and Suites

- 379 guestrooms
- 52 suites
- Six apartment-style residences

## Dining and Entertainment

### The Regency Bar & Grill

The Regency Bar & Grill: Loews Regency New York's signature restaurant and home of the famed "Power Breakfast", offers approachable and ingredient-forward dishes. Capturing the classic style of a refined bar and grill, the restaurant works with regional, organic farms and supports ecological fishing practices so guests who are looking for sustainable culinary options can enjoy quality food and drinks, time and time again. The Regency Bar is an Upper Eastside landmark where guests can enjoy hand-crafted specialty cocktails and fine wines.

### Sant Ambroeus Coffee Bar

Experience our espresso and cappuccino bar offerings and an assortment of desserts, pastries, croissants and paninis, served fresh daily in our brasserie or patio. Enjoy delectable cocktails and wines by the glass in the afternoon and evening hours as the perfect way to end your day and start your evening.

## Things to Do

- Steps away from the finest retailers in Manhattan
- Two blocks from Central Park
- Museums and popular attractions within minutes

## Meetings and Events

Four meeting rooms conveniently located on the same floor, featuring windows with natural light, built in audio visual with video conferencing capabilities. Ability to host intimate meetings and private meals inside The Regency Bar & Grill private dining room.

**Great Lawn:** This multi-purpose 700-square-foot meeting and event room has a small, private lounge area for breaks overlooking Park Avenue and 61st Street

**Sheep Meadow:** Seating for 20 people, with a small private lounge area for breaks overlooking 61st Street.

**Boathouse:** Seating for 15 people at a boardroom table, with a small lounge area contained in the meeting -Conservatory. Seating for 6 at a small boardroom table overlooking Park Avenue.

**Regency Room:** A 784 square-foot space in the back half of the The Regency Bar & Grill with the ability to be closed off from the balance of the restaurant with glass doors.

**Park Avenue Private Dining Room:** Intimate private dining room within The Regency Bar & Grill Will email capacity charts with mark ups directly.

## At Your Service

- Business center
- Julien Farel Restore Salon & Spa
- State-of-the-art fitness center
- Built in AV
- Room service
- On-site parking garage
- Complimentary internet access
- Chat Your Service: need a restaurant reservation or the AC turned up? Just text us and we've got you covered.



Top: meeting room  
Bottom: guestroom

Clockwise: guest suite, The Regency Bar & Grill, The Regency Bar & Grill private dining room