

Loews Santa Monica Beach Hotel

Offering unrivaled and newly renovated rooms and suites, the most distinctive outdoor space in Los Angeles and the quintessential Southern California meeting experience.

1700 Ocean Avenue
Santa Monica, CA 90401
310.458.6700
loewshotels.com/santamonica

Getting Here

Los Angeles International Airport: 11 miles
Santa Monica Airport: 4 miles

Rooms and Suites

347 newly renovated guestrooms, including four custom designed Signature Suites, 35 rooms with fire pits and 22 total suites.

Meetings and Events

30,000 square feet of flexible indoor and outdoor function space, including the 6,188 square foot Arcadia Grand Ballroom, four spaces featuring natural light and three spaces with ocean views, including the Ocean Terrace and Fireside Lounge—both offering unparalleled venues for intimate events with floor to ceiling windows and sweeping views of Santa Monica Beach and Pier.

Dining and Entertainment

Ocean & Vine

A spotlight on California cuisine featuring locally caught seafood and fresh produce from the Santa Monica Farmers' Markets.

BarBelle

Farm-to-table fare in a casual, oceanfront setting just steps from Muscle Beach.

Blue Streak

Lunch, lounge or linger late night, poolside or fireside. Cozy up by one of thirteen ocean view fire pits for s'mores and sunset views overlooking the Pacific.

Sunrise Breakfast Bar

Located in BarBelle and offering lattes, mochas, fresh fruit, smoothies, pastries and other on-the-go bites to start your day.

Things to Do

- Easy access to the ocean, Muscle Beach, The Pier and Spokes 'N Stuff for group activities
- Unwind after an eventful day and enjoy the sunset at one of our ocean view fire pits
- Wander down to Main Street, the Third Street Promenade and Santa Monica Place for a night on the town, all just a mile away
- Rent a bike and peddle just two miles to Abbot Kinney Boulevard in Venice Beach for a day of shopping and dining
- Grab a car service—we're just a short eight mile drive to Beverly Hills

At Your Service

- On-site A/V rentals, staging and production services through PSAV
- Full service FedEx business center
- On-site Hertz rental car services
- Heated swimming pool and hot tub
- Expansive fitness center with daily group fitness classes and yoga, plus state-of-the-art cardio and weight equipment
- Ocean Spa, featuring six treatment rooms and hair and nail salon services
- Santa Monica Green-Certified Business
- Chat Your Service: need a restaurant reservation or the AC turned up? Just text us and we've got you covered.

Lobby Level (Fourth Floor)

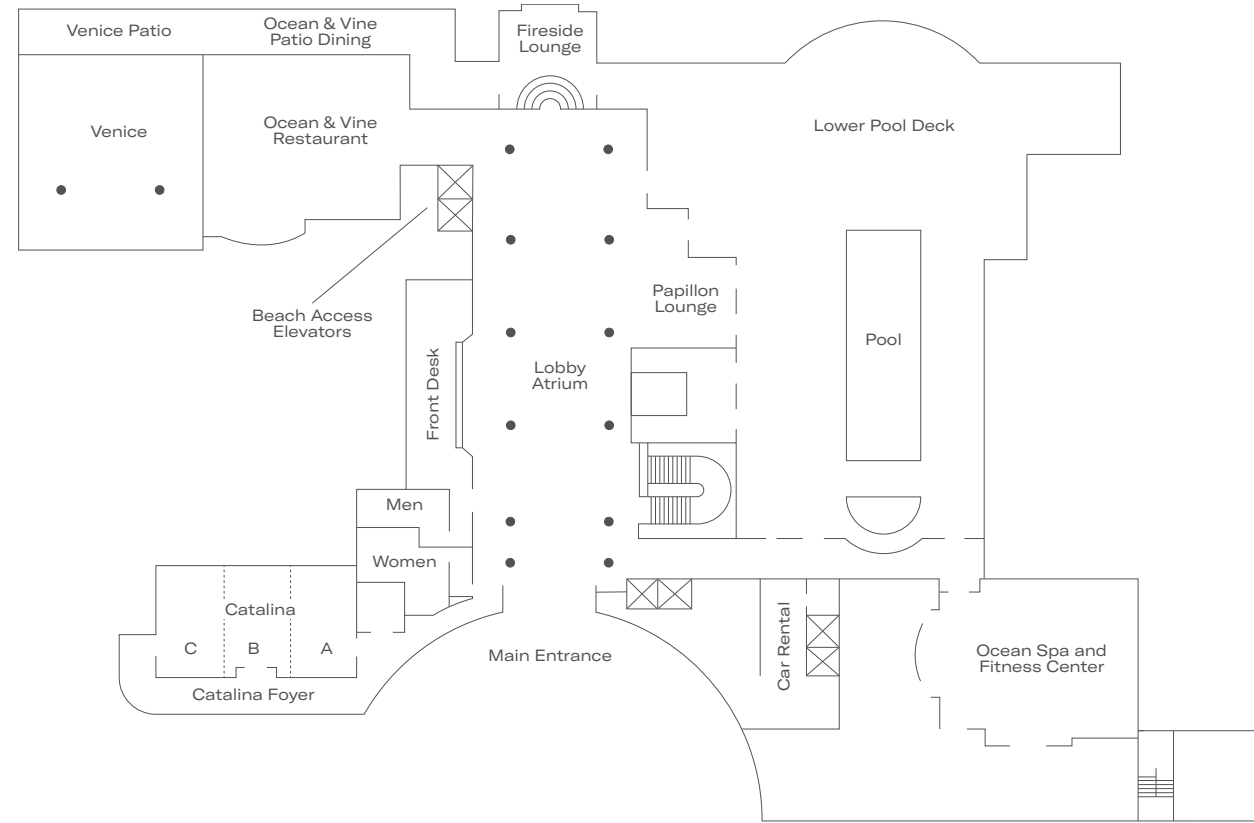

Room	Dimensions (Ft.)	Sq. Ft.	Ceiling (Ft.)	Classroom	Theater	Reception	Banquet
Lobby Level (Fourth Floor)							
Catalina Ballroom (A, B and C)	31 x 56	1,633	9	99	209	150	100
Catalina A	19 x 31	575	9	36	62	60	30
Catalina B	18 x 28	489	9	48	30	60	30
Catalina C	19 x 31	575	9	36	62	60	30
Catalina Foyer	23 x 81	922	10				
Venice Room	49 x 40	1,960	9	84	130	193	120



From left: guestroom, pool

SANTA MONICA BEACH





From top: hotel exterior, Arcadia foyer

Fifth Floor

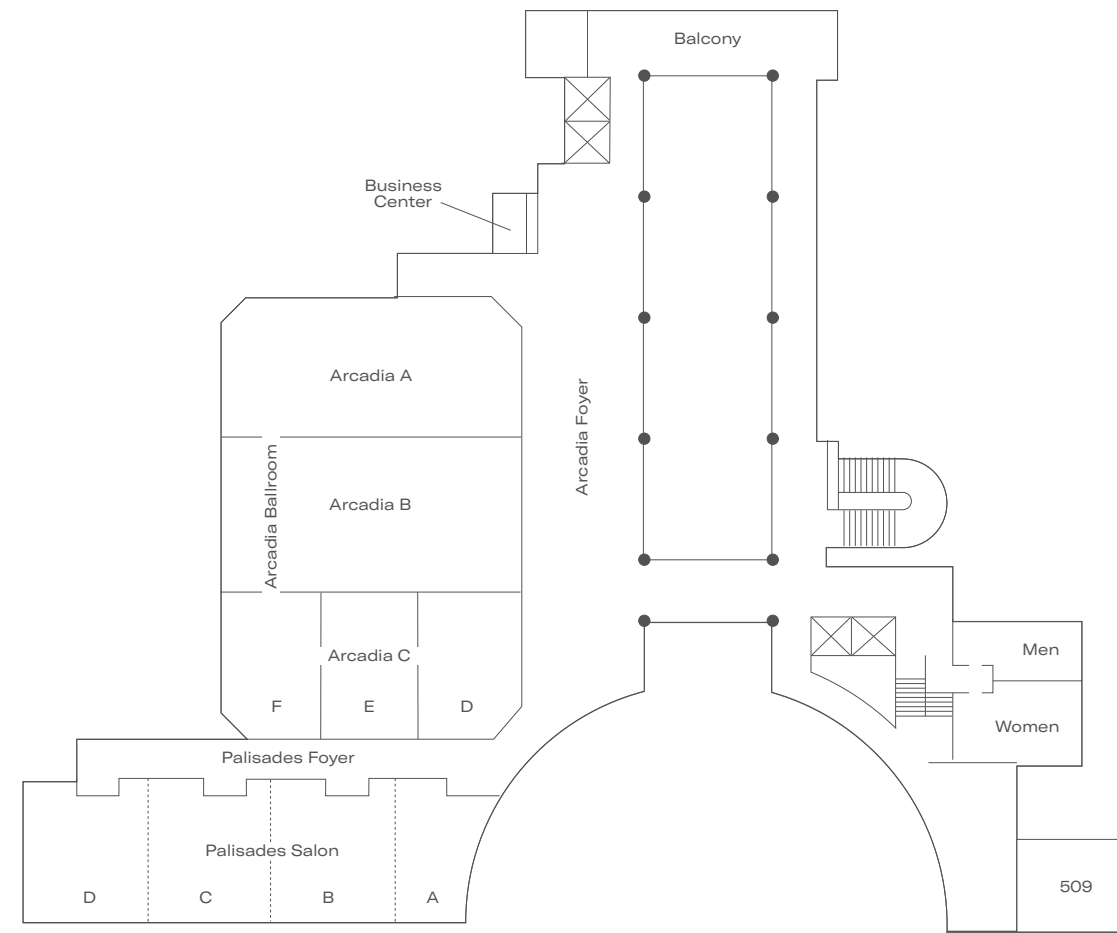

Room	Dimensions (Ft.)	Sq. Ft.	Ceiling (Ft.)	Classroom	Theater	Reception	Banquet
Fifth Floor							
Arcadia Ballroom	63 x 99	6,188	14	426	700	900	550
Arcadia A	32 x 63	2,001	14	126	240	225	170
Arcadia B	34 x 63	2,181	14	132	280	225	170
Arcadia C (D, E and F)	32 x 63	2,002	14	117	202	225	160
Arcadia D	21 x 32	657	14	30	66	60	40
Arcadia E	21 x 32	686	14	30	66	60	40
Arcadia F	21 x 32	659	14	24	52	60	40
Arcadia Foyer	154 x 32	3,312	15			300	
Palisades (A, B, C and D)	25 x 100	2,341	10	174	237	350	170
Palisades A	20 x 26	409	10	12	40	40	30
Palisades B	28 x 27	691	10	45	66	60	50
Palisades C	28 x 27	691	10	45	66	60	50
Palisades D	28 x 26	663	10	45	66	60	50
Palisades Foyer	12 x 96	787	9				
Room 509	18 x 29	319	8				
Balcony	153 x 53	1,869	7			60	40

Seventh and Eighth Floors

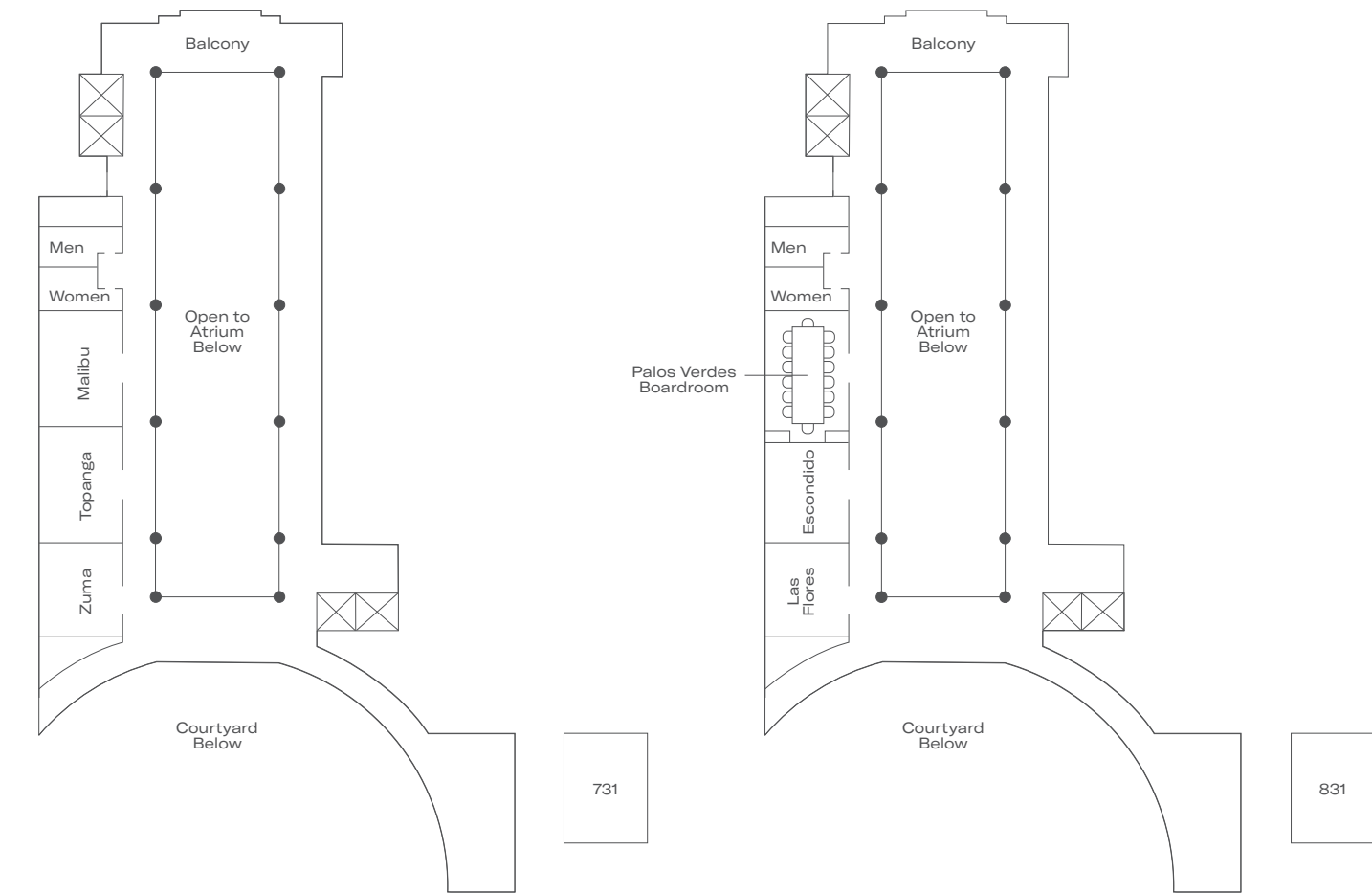

Room	Dimensions (Ft.)	Sq. Ft.	Ceiling (Ft.)	Classroom	Theater	Reception	Banquet
Sixth Floor							
Suite 631	28 x 38	712	8	21	35	50	30
Balcony	153 x 53	1,869	7			60	40
Seventh Floor							
Malibu	18 x 25	435	7	36	64	40	30
Topanga	18 x 25	439	7	36	64	40	30
Zuma	18 x 20	358	7	30	54	40	20
Suite 731	28 x 38	794	7	21	35	50	30
Balcony	153 x 53	1,869	7			60	40
Eighth Floor							
Palos Verdes Boardroom	17 x 30	480	7	Permanent Boardroom Table, Seating for 14			
Escondido	18 x 23	396	7	30	40	40	20
Las Flores	18 x 22	388	7	30	40	40	20
Suite 831	29 x 39	710	8	Boardroom Table, Seating for 22			
Balcony	153 x 53	1,934	25			80	40