

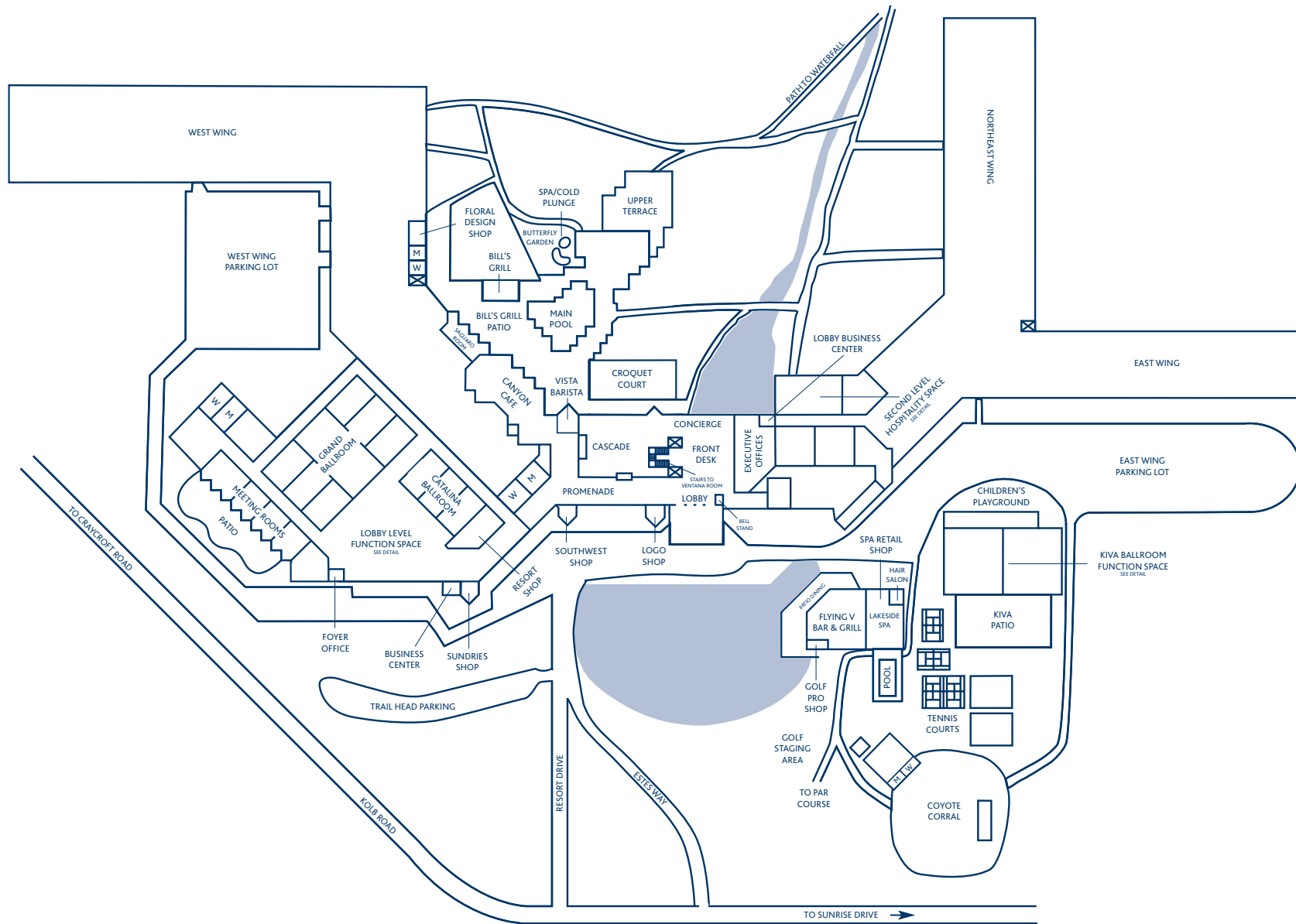

LOEWS

VENTANA CANYON

Floorplan Specifications



PROPERTY OVERVIEW

Loews Ventana Canyon

| Room | Dimensions | | Capacity | | | | | | |
|---------------------------|------------------|--------------|----------|-----------|-----------|---------|-----------------|------------------|---------|
| | Feet/Square Feet | Ceiling (ft) | Theatre | Classroom | Reception | Banquet | Exhibits (8x10) | Exhibits (10x10) | U-shape |
| Lobby Level | | | | | | | | | |
| Grand Ballroom (A+B+C) | 125 x 71 / 8,875 | 16 | 750 | 460 | 900 | 660 | 54 | 40 | |
| Salon A (D+E+F) | 71 x 40 / 2,840 | 16 | 250 | 150 | 280 | 210 | 17 | 12 | 70 |
| Salon B | 71 x 45 / 3,195 | 16 | 300 | 160 | 300 | 230 | 19 | 14 | 70 |
| Salon C (G+H+I) | 71 x 40 / 2,840 | 16 | 250 | 150 | 280 | 210 | 17 | 12 | 70 |
| Salons E,F,H,I | 40 x 24 / 960 | 16 | 80 | 54 | 80 | 60 | | | 30 |
| Salons D,G | 40 x 23 / 920 | 16 | 80 | 54 | 80 | 60 | | | 30 |
| Grand Ballroom Foyer | 6,689 | 10 | | | 800 | 350 | 28 | 24 | |
| Catalina Ballroom (J+K+L) | 74 x 43 / 3,139 | 12 | 280 | 160 | 280 | 220 | 16 | 12 | 70 |
| Salon J | 43 x 25 / 1,075 | 12 | 80 | 54 | 80 | 60 | | | 30 |
| Salons K,L | 43 x 24 / 1,032 | 12 | 80 | 54 | 80 | 60 | | | 30 |
| Executive Boardroom | 42 x 19 / 798 | 10 | 70 | 40 | 70 | 50 | | | 30 |
| Sabino | 19 x 28 / 532 | 10 | 54 | 24 | 50 | 40 | | | 24 |
| Santa Rita | 19 x 28 / 532 | 10 | 54 | 24 | 50 | 40 | | | 24 |
| Rincon | 19 x 28 / 532 | 10 | 54 | 24 | 50 | 40 | | | 24 |
| Coronado | 24 x 25 / 600 | 10 | 54 | 32 | 60 | 50 | | | 24 |
| Sonora | 19 x 28 / 532 | 10 | 54 | 24 | 40 | 40 | | | 22 |
| Canyon Cafe | 43 x 85 / 3,655 | 10 | | | 150 | 120 | | | |
| Saguaro | 19 x 28 / 532 | 10 | 54 | 30 | 50 | 40 | | | 20 |
| Bill's Grill | 4,000 | | | | 230 | 200 | | | |
| Croquet Court | 1,200 | | | | 175 | 130 | | | |
| Flying V | 39 x 34 / 1,020 | 12 | | | | 120 | | | |
| Flying V Deck | 67 x 14 / 938 | N/A | | | | 120 | | | |

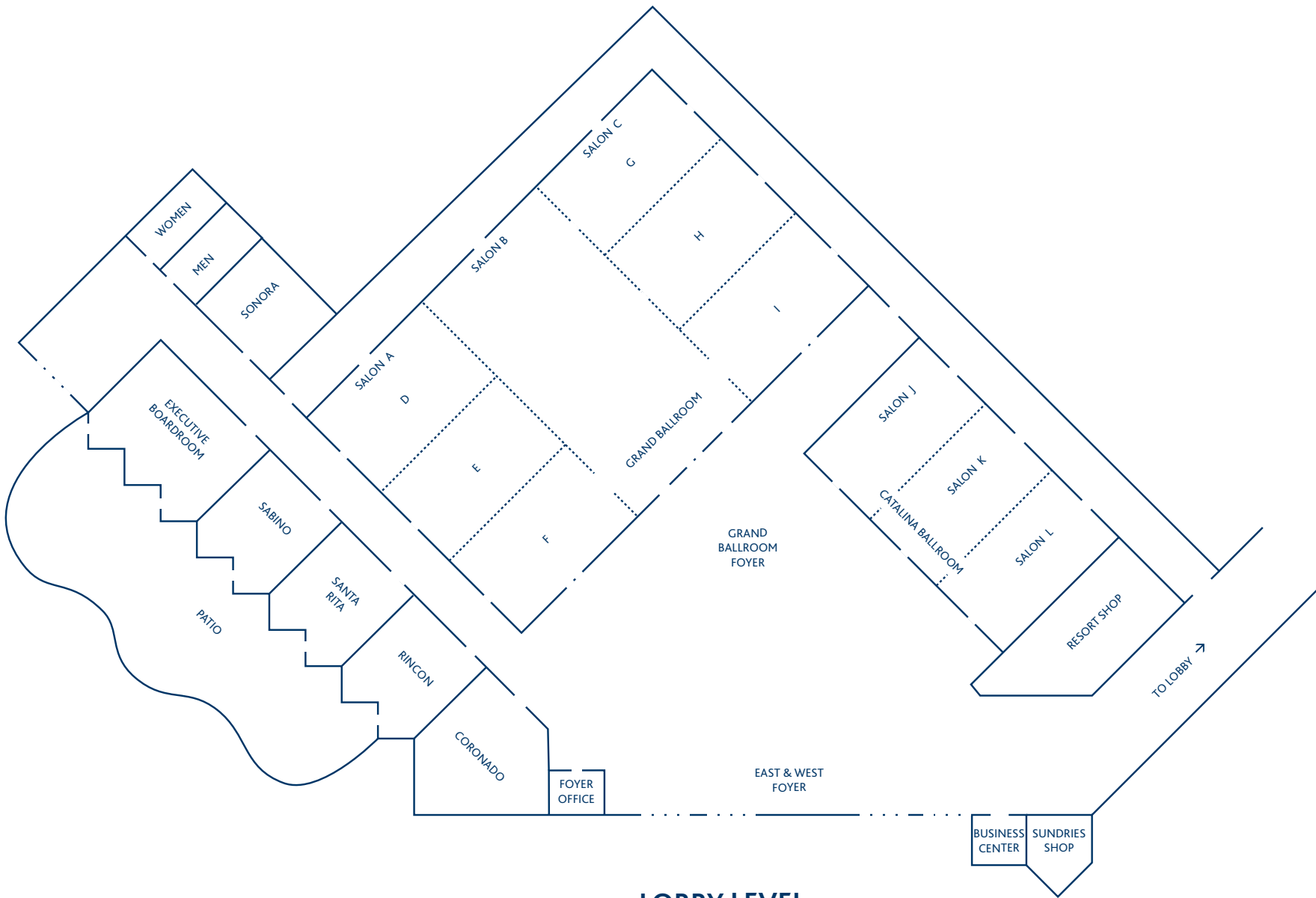

LOBBY LEVEL

Loews Ventana Canyon

| Room | Dimensions | | Capacity | | | | | |
|---------------------------------|-------------------|--------------|----------|-----------|-----------|---------|-----------------|------------------|
| | Feet/Square Feet | Ceiling (ft) | Theatre | Classroom | Reception | Banquet | Exhibits (8x10) | Exhibits (10x10) |
| Second Level Hospitality | | | | | | | | |
| Parlor 2205 | 1,008 | 9 | 65 | 36 | 70 | 50 | | |
| Parlor 2211 | 868 | 9 | 28 | 24 | 40 | 20 | | |
| Parlor 2202, 2206 | 868 | 9 | 35 | 20 | 50 | 30 | | |
| Parlor 2210 | 728 | 9 | 24 | 16 | 50 | 20 | | |
| Ventana Room | 110 x 22 / 2,000 | 10 | | | 150 | 100 | | |
| Ventana Private Dining Room | 14 x 23 / 322 | 7 | | | | | | |
| Kiva Building | | | | | | | | |
| Kiva Ballroom (A+B) | 90 x 120 / 10,800 | 18 | 900 | 550 | 1,000 | 740 | 62 | 45 |
| Kiva A,B | 90 x 60 / 5,400 | 18 | 450 | 275 | 500 | 350 | 33 | 22 |
| Kiva Patio | 8,000 | | | | 1,000 | 620 | | |
| Outdoor Function Areas | | | | | | | | |
| Coyote Corral | 22,000 | | | | 900 | 500 | | |
| Upper Terrace | 3,000 | | | | 200 | 150 | | |

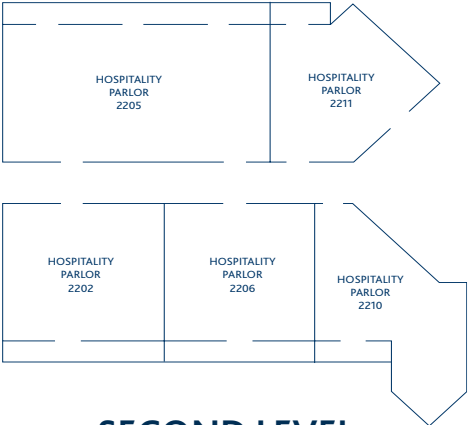

SECOND LEVEL HOSPITALITY

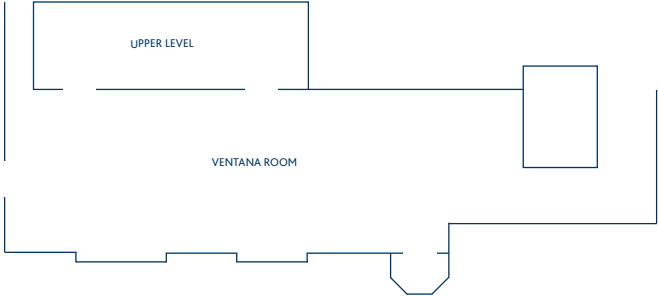

VENTANA ROOM

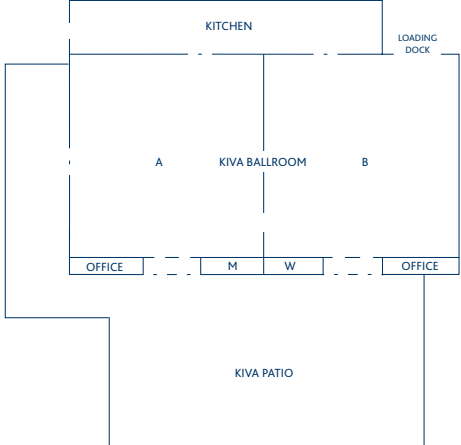

KIVA BUILDING

Notes:

Loews Ventana Canyon
7000 N Resort Drive Tucson AZ 85750
Tel 520.299.2020 Fax 520.299.4151
loewshotels.com/ventanacanyon



LOEWS
VENTANA CANYON